

TRANSFER ASSEMBLY

< SERVICE INFORMATION >

- After the installation, check the 4WD shift indicator pattern. If NG, adjust the position between the transfer assembly and transfer control unit. Refer to [TF-4, "Precaution for Transfer Assembly and Transfer Control Unit Replacement"](#).

Disassembly and Assembly

INFOID:000000001613923

COMPONENTS

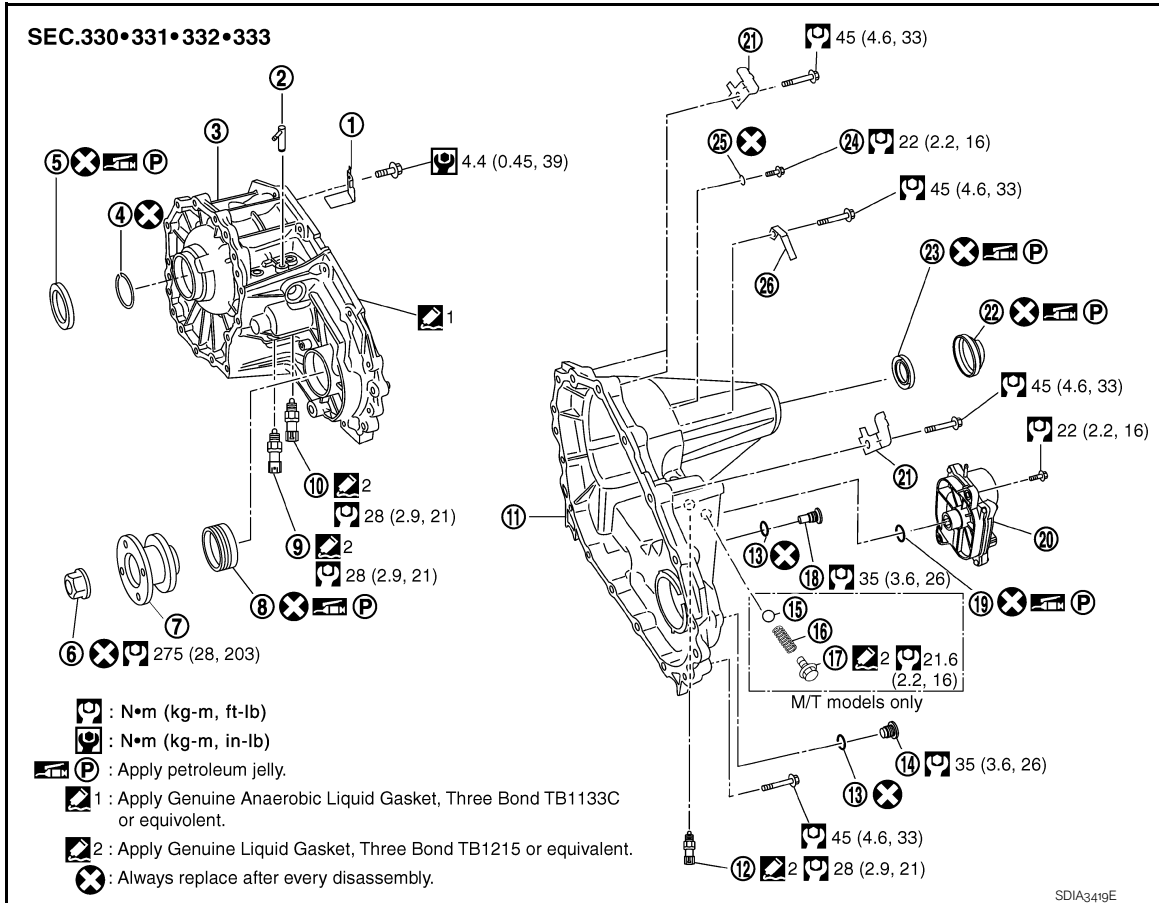

- | | | |
|------------------------|-----------------------------|---------------------------------------|
| 1. Baffle plate | 2. Breather tube | 3. Front case |
| 4. Snap ring | 5. Input oil seal | 6. Self-lock nut |
| 7. Companion flange | 8. Front oil seal | 9. 4LO switch (gray with green paint) |
| 10. ATP switch (black) | 11. Rear case | 12. Wait detection switch (gray) |
| 13. Gasket | 14. Filler plug | 15. Check ball |
| 16. Check spring | 17. Check plug | 18. Drain plug |
| 19. O-ring | 20. Transfer control device | 21. Harness bracket |
| 22. Dust cover | 23. Rear oil seal | 24. Retainer bolt |
| 25. Gasket | 26. Air breather hose clamp | |